



10 Chatsworth Close, Shaw

£239,950

🛏️ 3 🚿 1 🚗 1



- Semi Detached
- Three Bedrooms
- West Facing Rear Garden
- Close To Shaw Centre
- Small Cul De Sac
- Two Reception Rooms
- Large Driveway
- EPC: C



Offered for sale is this well presented three bedroom semi detached family home located in this tucked away spot in Shaw. Accommodation comprising: Entrance porch/hallway, lounge, dining area and a kitchen. To the first floor there are three bedrooms and a lovely bathroom. Externally there is a West facing rear garden, and a large front driveway for three cars. There is a very useful storage garage with a home office/ playroom attached. Close to wonderful schools and within easy reach of Shaw town centre and the local Metro link into Manchester. Call us today to arrange a viewing on what could be your next home! This property is freehold.

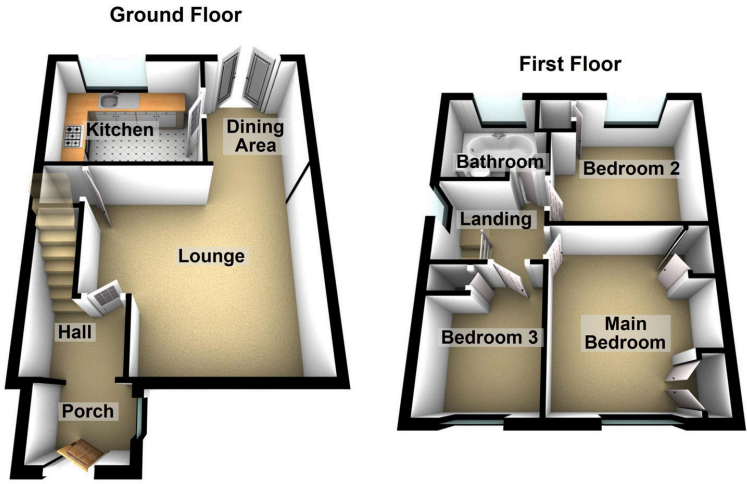

Energy Efficiency Rating		
	Current	Potential
Very energy efficient - lower running costs		
(92 plus) A		
(81-91) B		86
(69-80) C	72	
(55-68) D		
(39-54) E		
(21-38) F		
(1-20) G		
Not energy efficient - higher running costs		
England & Wales	EU Directive 2002/91/EC	

Chadderton Office
 509 Middleton Road,
 Chadderton, Oldham,
 OL9 9SH

chadderton@kirkham-property.co.uk
 t: 0161 626 5688